



Edgetech, Inc.
11933 12th Avenue South
Burnsville, MN 55337 USA
952-881-1925
fax 952-881-0374
www.EdgetechUSA.com

Manufacturer of Postforming and Laminating Machinery

CTSg2 Countertop Saw

Edgetech Countertop Saws produce precise square and miter cuts on countertops and bartops.

Custom sized countertops can be easily produced by indexing the saw to the desired angle for cutting, followed immediately by the routing of drawbolt cavities without any additional handling of the countertop.

Standard Features

- 90°, 45° and 22½° miter positions
- Pneumatic retraction of index pin when indexing saw to different cutting position
- Variable speed traverse in cutting direction
- Choice of full or variable speed traverse in return direction (variable speed allows controlled cutting to be made into the nose of the top for special applications)
- Drawbolt routing function
- Four 1¾ HP router motors
- Fully visible router template allows operator to ensure proper routing of drawbolt cavities
- Router guide pin with a rotating shaft for ease of operation and reduced wear to template
- Pneumatic holddown clamping cylinders (4) independently positionable
- PLC controlled operations
- Pressure switch sensing (holddown cylinders)
- Maintenance free DryLin® Bearings
- UHMW fence pads - mar free bartop alignment
- Cable-track for air hoses & electrical wiring
- Solid state proximity switches-carriage traverse
- Carbide tipped triple chip saw blade 16"
- Carbide tipped router bits ½" dia. x 2-5/8"



Optional Features

- Gravity roller conveyors – 10' length - pair
- Dual laser alignment system to indicate precisely where the cut will be made
- Variable miter with digital readout for cutting non-standard angles between 0° - 47°
- Pneumatic backslash clamps for pulling the countertop tight to the fence
- Support rings for additional support of shorter countertops
- Telescoping conveyors attach to the saw frame and move with the saw when pivoted
- 5th router
- 20" blade
- Dust collection system (3 HP) with drums, lateral & hoses
- Automatic start/stop of dust collection system
- Single phase converter – converts single phase to 3 phase power



Edgetech, Inc.
 11933 12th Avenue South
 Burnsville, MN 55337 USA
 952-881-1925
 fax 952-881-0374
 www.EdgetechUSA.com

Manufacturer of Postforming and Laminating Machinery

Countertop Saw Specifications

Submit profiles for review. Some restrictions may apply to combinations of these dimensions.

Model		CTSg2	CTSg2-20
Max. panel size (3/4" thick board)	90°	57"	53"
	22 1/2°	52"	49"
	45°	40"	37"
Max. cutting height from bottom of countertop deck		5"	7"
Max. cutting height including nose builddown		5 3/4"	7 3/4"
Electrical requirement		208-230V / 3 Phase	35 Amp (40 Amp w/ 5 th Router)
Air requirement		80 - 140 PSI	80 - 140 PSI
Machine working height		35 1/2"	35 1/2"
Machine height without laser (with laser)		67" (75")	69 1/2" (77 1/2")
Machine width x length		84" x 113"	84" x 113"
Shipping weight (approximate)		2,300 lbs.	2,500 lbs.

Production capacities and specifications are provided for the convenience of our customers and are not binding. Edgetech reserves the right to make changes without notice. Please contact us if the above capacities and/or specifications do not meet your requirements.

Engineering Floor Plan

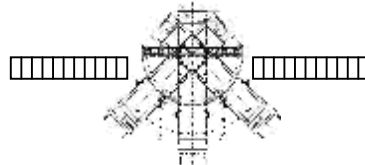
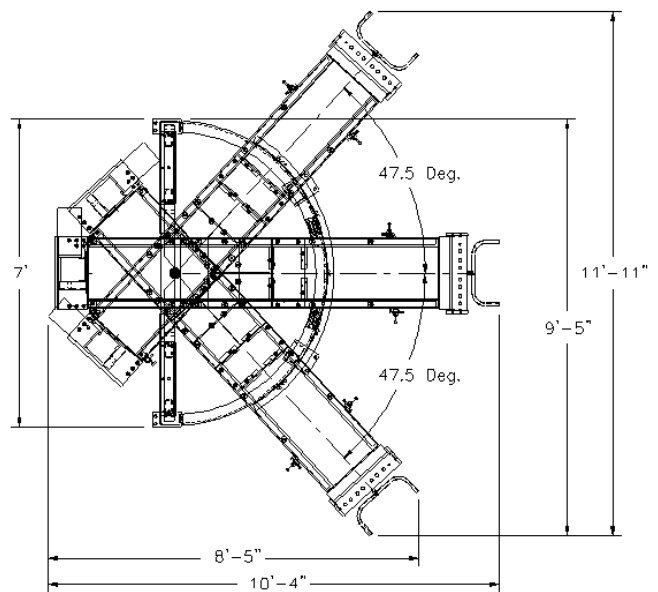

Note: Optional gravity conveyors are typically positioned at both sides of the saw base frame. The gravity conveyors are 10 feet long each, so the overall width (including conveyors) would be approximately 28 feet. Dimension from a rear wall to the front of the machine would depend on clearance required for electrical enclosure, but would be approximately 14 feet.



Edgetech, Inc.
 11933 12th Avenue South
 Burnsville, MN 55337 USA
 952-881-1925
 fax 952-881-0374
 www.EdgetechUSA.com

Manufacturer of Postforming and Laminating Machinery

Countertop Saw Optional Equipment



Support Ring



Dual Laser Alignment



Gravity Conveyors



Backsplash Clamps (Pair)



Dust Collection System



Variable Mitre



Telescoping Conveyors



Edgetech, Inc.
 11933 12th Avenue South
 Burnsville, MN 55337 USA
 952-881-1925
 fax 952-881-0374
 www.EdgetechUSA.com

Manufacturer of Postforming and Laminating Machinery

Features that give Edgetech Countertop Saws the Edge



Rugged frame with welded gusset supports

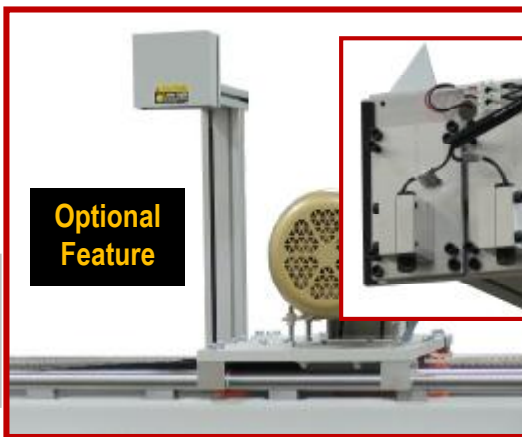

Optional Feature

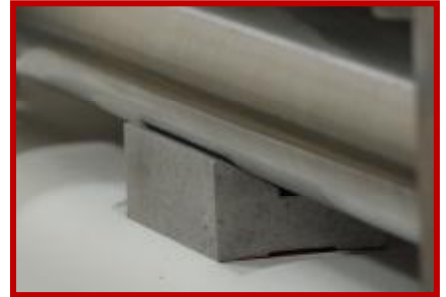

All pillow block locations on upper frame are CNC machined for flatness to ensure precise rail alignment



PLC Control promotes safety

Dual Laser shows the exact location & width of cut, eliminating any doubt of where the cut will be made.

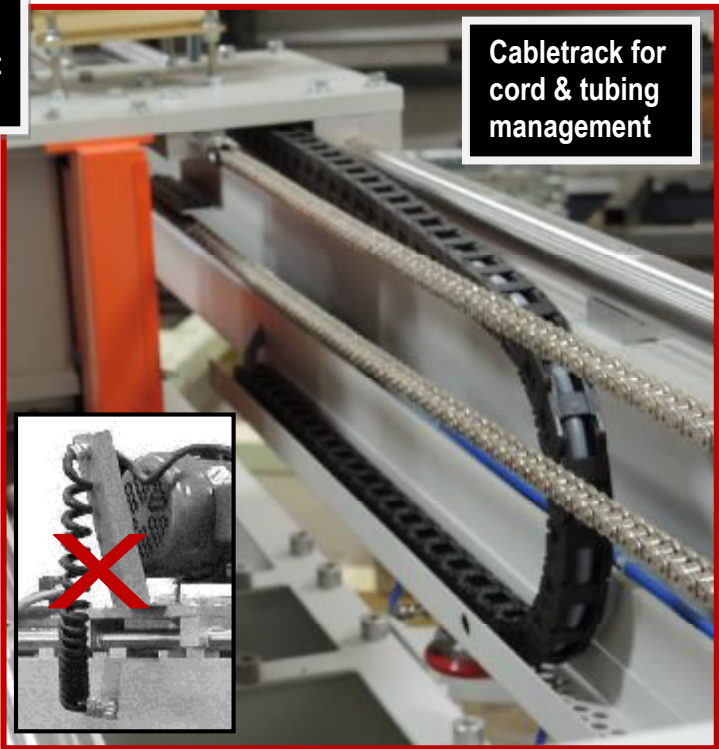

Cabletrack for cord & tubing management

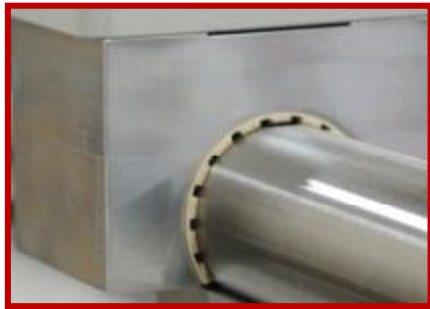

Maintenance free, long life DryLin® Bearings



Selection of Variable Speed in either direction

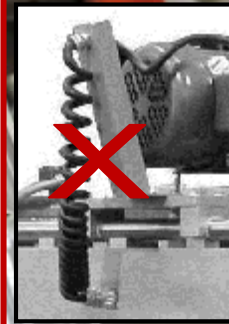

Optional Feature
Compare our ruggedly built Variable Mitre



Easy Grip Handle

These are just some of the features that Edgetech has incorporated into our countertop saws. We would appreciate the opportunity to visit with you about how these and other features of the Edgetech saw make it the best choice in the industry.

Features listed are standard unless noted



UHMW fence pads for mar free bartop alignment